

Baby Grande or Grande Motorized Shade with Cables and Housing Installation Instructions

Tools Needed	Hardware Provided (per shade)	Hardware Needed
<p style="text-align: center;">Drill</p> <p>3/8" Metal Drill Bit</p> <p>Measuring Tape</p> <p>Pencil</p> <p>4" Level</p> <p>Plumb Line</p> <p>1/4" Masonry Drill Bit</p> <p>Hammer</p> <p>Linesmans Plie rs</p> <p>Cable Cutters</p> <p>1/2" Metal Drill Bit</p>	<p style="text-align: center;">End Caps (Brackets) (2)</p> <p style="text-align: center;">Housing (1)</p> <p style="text-align: center;">Shade Fabric Tube (1)</p> <p style="text-align: center;">Turnbuckles (2)</p> <p style="text-align: center;">Tie Wire Drives (Cable Anchors) (2)</p> <p style="text-align: center;">Copper Lugs with Set Screws (2)</p> <p style="text-align: center;">Cables(2persshade) (2)</p> <p style="text-align: center;">Remote (1) per order</p> <p style="text-align: center;">Motor Clip(1)</p>	<p style="text-align: center;">5/16" X4 1/2" LagScrewsor Appropriate(4 or more)</p> <p style="text-align: center;">3/8" Flat Washers or Appropriate (4 per shade)</p> <p style="text-align: center;">Wire Nuts</p>

[*Instruction Pictures Go From Left to Right]

1. Prepare Back of Housing

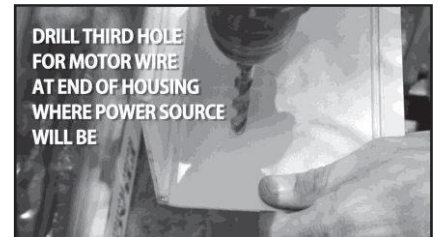
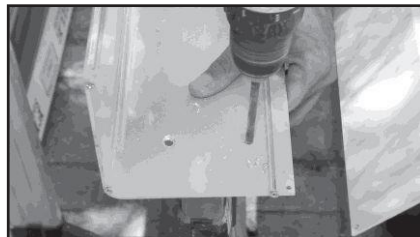

FOR BABY GRANDE: Starting at one at end of housing, make two mounting hole marks 1 1/4" in from end cap on your housing. This is so that the bolt heads will not be behind the fabric roll so they cannot contact the fabric and damage it. You will need to 'toe nail' the bolts (insert at an angle.)

FOR GRANDE: Starting at one end of the housing, make two mounting hole marks 2" in from the end cap on your housing.

Using a 3/8" metal drill bit, drill the two mounting holes. Repeat this process on other side of housing with other end cap. Drill a third hole for motor wire at end of housing where power source will be (within 1 1/4" from end cap). It is best to run motor wire through side or bottom of housing, be sure wire will not interfere with operation of the shade. If drilling top, wire hole MUST be sealed to prevent water damage to motor. **[Note: Top mount holes are on top of the housing, surface mount holes are on back of the housing. Pictures above demonstrate surface mount holes.]**

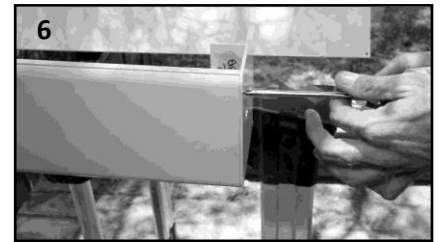
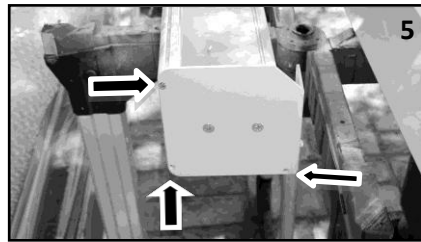

[STEPS 1-3] Start at one end of housing and remove 3 screws attached to housing and set aside. Repeat same process on other side of housing.

[STEPS 4-6] Align motor end bracket up to screw holes (holes you just removed screws from) and secure using 3 screws you set aside with Phillips screwdriver (Arrows pointing to holes in bracket). Repeat same process on opposite side with bearing end bracket.

2. Hang Back of Housing – 2 Person Job



[STEPS 1-3] Once you decide where your housing will hang, hold back of housing up to surface and starting on one side, drill starter holes into mounting surface and secure first lag screw and washer on top hole. Make sure your housing is level. Repeat process on other side of housing.

[STEPS 4-5] Once housing is secure by itself, bolt your final bottom two lags and washers on each side. Bolts must be installed in upper corner of box—keep away from center of box, the area needs to be clear for the fabric roll.



Remove hood screws on both sides of housing located underneath the brackets and set aside.

3. Hang Tube With Fabric - 2 Person Job



Remove bottom rail from pocket of shade fabric.

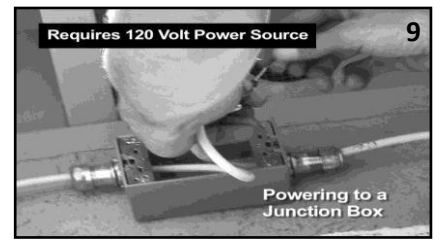
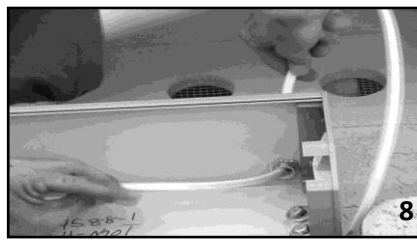
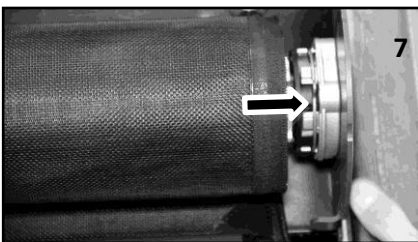
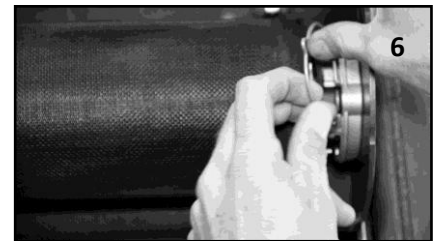
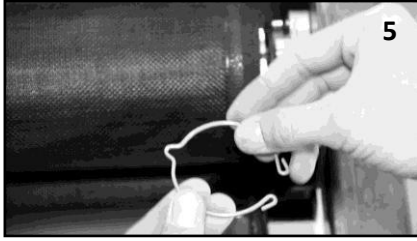
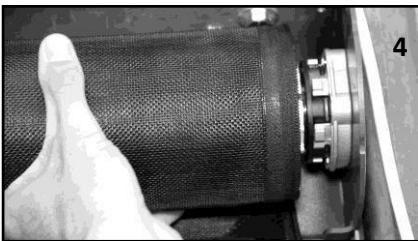
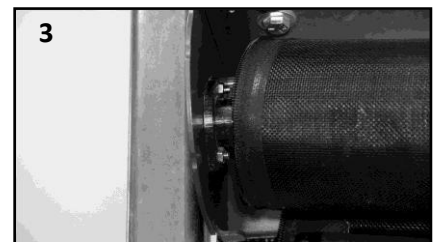
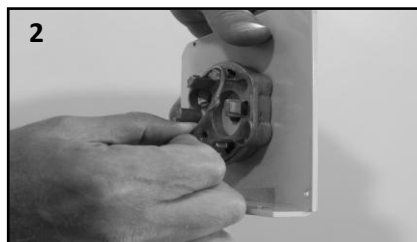
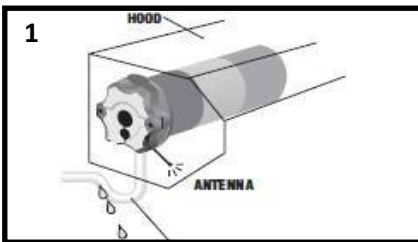

PLEASE NOTE: In order to avoid water penetration, form a "drip loop" with the power cable and use hood when required (#1). Remove motor clip from star bracket; set aside (#2). Remove bolt from cradle idler and place white bearing on idler pin end. Make sure wire is placed in side channel (under yellow cap). Slip round pin into idler (#3). Push shade in and replace bolt to lock in place (#3). Slide motor end of shade into star bracket (#4). Reinstall motor clip onto bracket, making sure mouth snaps in place over bracket and motor head (#5-7). Feed motor wire through third hole in housing (#8). Tie motor wire into electrical source, such as junction box or plug in (#9).



Using provided remote, lower shade slightly by pressing down arrow. Put bottom rail back into pocket of fabric.



4. Drill Holes For Cable Anchors-Skip if using HD L Brackets



Use Plumb Line to hang from hole in housing (where pointing to in picture) down to ground. Mark spot with pencil for cable anchor. Drill hole with $\frac{1}{4}$ " masonry drill bit. Hammer in tie wire drives. **[NOTE: Tie wire drives should be hammered in as far as they can go.]** Repeat process on the other side.

5. Setting Up/Attaching Cables

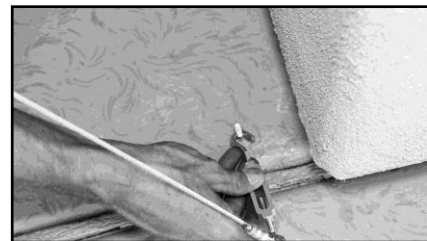
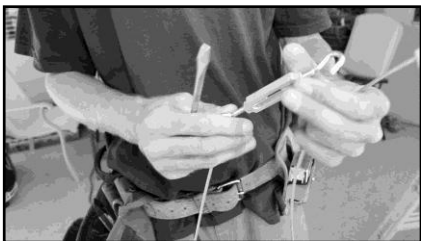

Open turnbuckles by unscrewing each end until $\frac{1}{4}$ " thread remains inside turnbuckle housing. Attach hook end of turnbuckle to tie wire drive.



At the top of the cable, you will find a small cable clamp that is already attached. With a flat head screw driver, unscrew front setscrew and remove clamp from cable. Set aside.

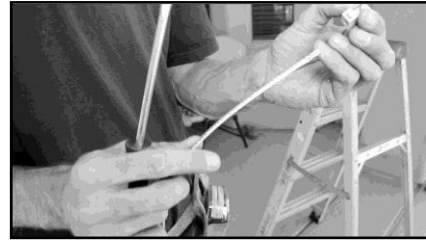

With a flat head screw driver, unscrew front setscrew and remove clamp from cable. Set aside.

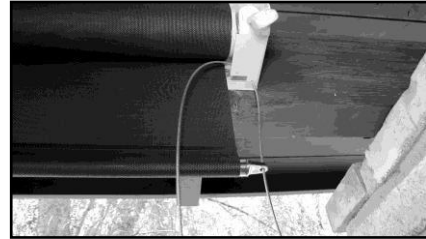
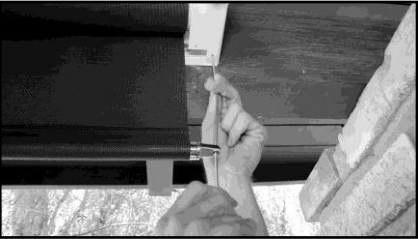

Slip cable up through the eyelet of bottom rail and push up through small hole in bottom of end cap. Continue pulling until top of cable is in reach for you to grasp. Using cable cutters, cut cable to proper length.

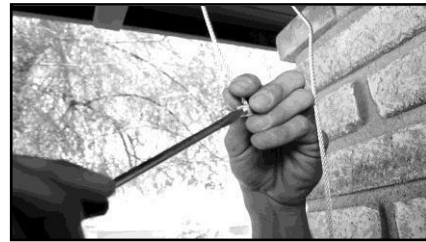
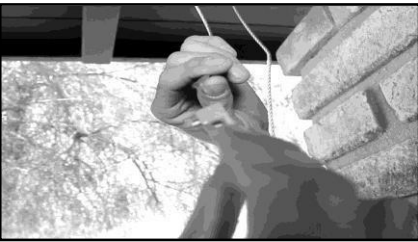

Insert cable through clamp and using a flat head screwdriver, tighten down the setscrew.

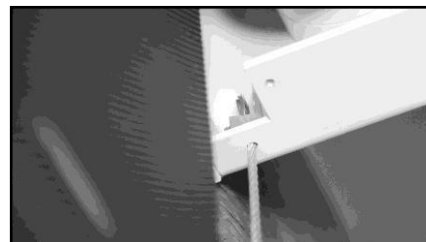
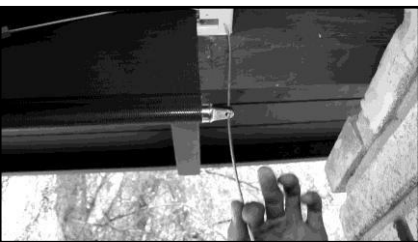

Once clamp is secured, pull cable from just underneath bottom bar eyelet until clamp rests on bottom of housing end cap (as shown).



Close turnbuckles to add tension to cables. (Hold top and turn buckle clockwise).



Repeat whole process on other side.

6. Safety Wire Turnbuckles

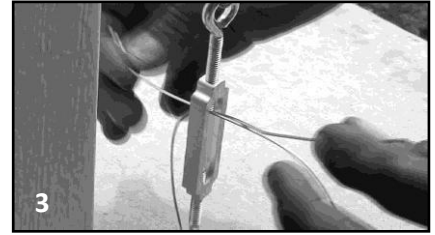
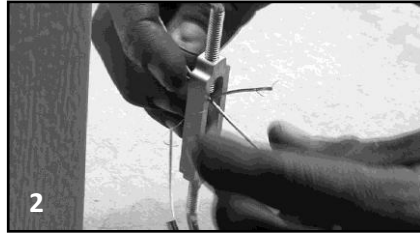
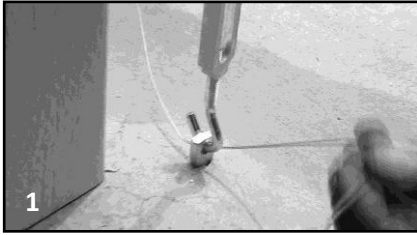

Using left over cable, unravel two strands of wire about 10" in length. Weave strands of wire through tie wire, turnbuckle and then cable loop. Use pliers to twist wire tight. Cut off excess. This prevents the turnbuckle from twisting and loosening the cables. You will repeat this on the other side.

7. Install Front/Bottom Housing

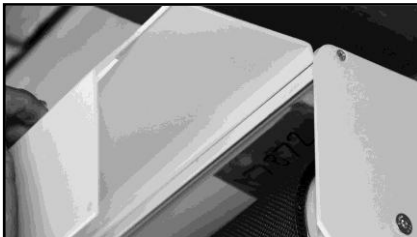

Set housing into groove at top and bring down to set into place.

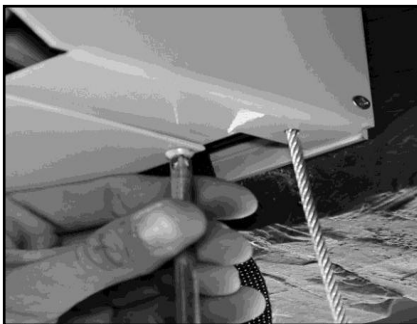

Install the two hood screws you put aside earlier onto bottom of front housing to secure, one on each side.



8. Adjust Motor Limits



[NOTE: Motors come pre-programmed with short limits.] To change the lower limit, send the motor to its current lower limit by pressing the down arrow. Press both the up and down button at the same time until the motor jogs. Adjust to your desired lower limit position and press the “my” button until the motor jogs. This saves your lower limit. To change the upper limit, send the motor to its current upper limit. Press both the up and down buttons at the same time until the motor jogs. Adjust to your desired upper limit position and press the “my” button until the motor jogs. This saves your upper limit.

9. Confirm Limits

Send the shade to both the upper and lower limits. The shade should roll up and down on cable guides and stop on its own at the programmed limit settings.

You're done! Enjoy!

