

Motorized (XQ5 Premium) or Crank Operated Fortress Zipper Track Shade with Housing and Side Track Installation Instructions

Tools Needed	Hardware Provided (per shade)	Hardware Needed
<p style="text-align: center;"> Drill 3/8" Metal Drill Bit 1/4" Masonry Drill Bit Measuring Tape Pencil 4" Level Phillips #2 Driver Manual Screwdriver (Phillips) Mitre Saw 5/32" allen wrench to adjust round pin if necessary </p>	<p style="text-align: center;"> End Caps (Brackets) (2) Housing (1) Shade Fabric Tube (1) Side Tracks (2) with PVC fabric guides If Motorized, Motor Clip (1) remotes or sensors as ordered If manual, crank gear (1) and one hand brace per ORDER L Channel brackets for inside mount (2) if ordered </p>	<p style="text-align: center;"> 5/16" X 4 1/2" Lag Screws or Appropriate (4 or more) 3/8" Flat Washers or Appropriate (4 per shade) 2 1/2" Drywall Screws (6- 8) Sheet metal screws (6—8) (To install track to optional "L" Channel Mounting Bracket) </p>

Important Note: Due to the nature of the product, mounting procedures may vary. Where applicable, the installer must determine the best choice of mounting screws necessary for the specific installation. If installing optional "L" Channel brackets please read all instructions before installation.

[*Instruction Pictures Go From Left to Right]

1. Prepare Back of Housing

Before starting, ensure that neither part of the housing is bent and that they fit together by assembling just the front and back on the floor.

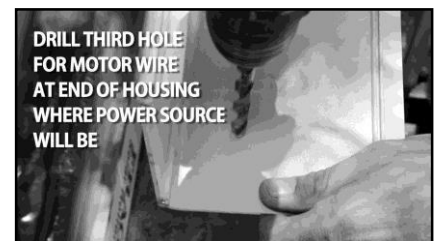
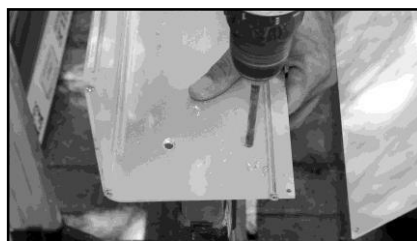

Starting at one at end of housing, make two mounting hole marks 2" (for 5 1/2" housing) or 1 1/8" (for 4 1/2" housing) in from end cap on your housing. Using a 3/8" metal drill bit, drill the two mounting holes. Repeat this process on other side of housing with other end cap. If motorized, drill a third hole for motor wire at end of housing where power source will be. It is best to run motor wire through side or bottom of housing. If drilling top, wire hole MUST be sealed to prevent water damage to motor. **[Note: Top mount holes are on top of the housing, surface mount holes are on back of the housing. Pictures above demonstrate surface mount holes.]**

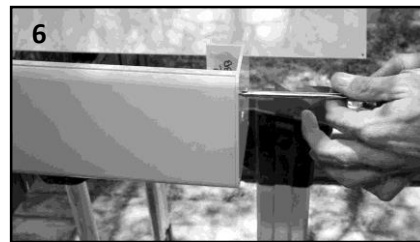
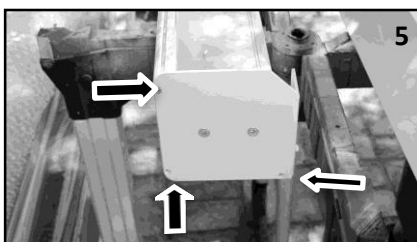
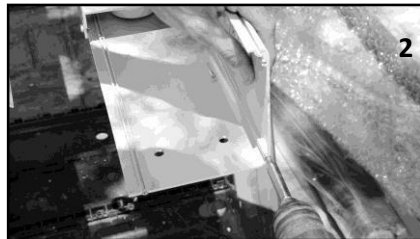

[STEPS 1-3] Start at one end of housing and remove 3 screws attached to housing and set aside. Repeat same process on other side of housing.

[STEPS 4-6] Align motor end bracket or crank gear bracket up to screw holes (holes you just removed screws from) and secure using 3 screws you set aside with Phillips screwdriver (Arrows pointing to holes in bracket). Repeat same process on opposite side with bearing end bracket.

BEFORE attempting to install on mounting surface: Put front and back housing together on the floor to make sure that the parts fit together. If the leading edges are malformed, or if either housing piece is bent, they will not assemble correctly. Contact us for help. This is usually caused by shipping damage. If they go together correctly proceed with the installation. If difficulty is experienced putting the front on once the back is mounted, this usually means the mounting surface is not flat and bolting it down has pulled the housing temporarily out of shape, and you will need to loosen the bolts and use spacers so that the back housing is flat.

2. Hang Back of Housing - 2 Person Job





FOR INSIDE MOUNT: You need to install the L Channel brackets before the housing as they go the full height of the opening and behind the housing. Cut the "L" Channel Brackets to required length. For most installations these should go from the floor to the top of the opening, continuing along the sides of the shade housing on either side. Next, install them. The back (2 ½" leg) of the brackets should be lined up with the back of the housing with the 1" leg flush against the inside of the opening. Make sure the bracket is mounted level to the inside of the opening, going from top to bottom. It is recommended that you pre-drill the bracket prior to final installation to the inside of the opening (do not pre-drill for the side track attachment at this time). Put in the top mounting fastener, then level the channel and put in the bottom fastener to maintain the level. Complete this installation by securing bracket with additional fasteners, top to bottom, ensuring the bracket remains level.

[STEPS 1-4] Once you decide where your housing will hang, hold back of housing up to surface and starting on one side, drill starter holes into mounting surface and secure first lag screw and washer on top hole. Make sure your housing is level. Repeat process on other side of housing.

[STEPS 5-6] Once housing is secure by itself, bolt your final bottom two lags and washers on each side.

3. Installation of the roller tube and fabric assembly- 2 Person Job

MOTORIZED

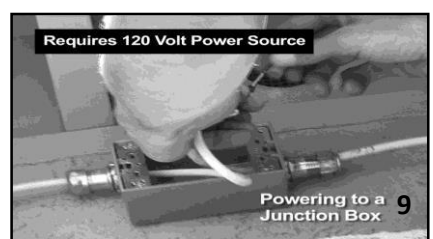
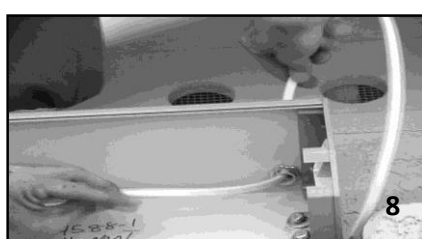
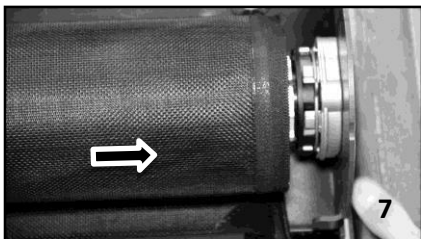
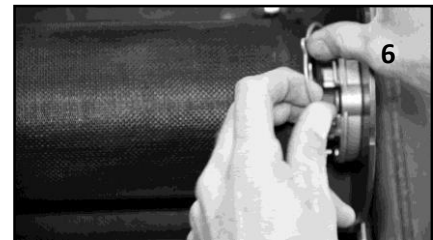
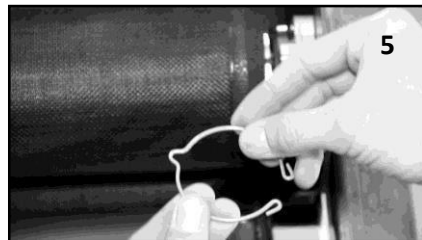
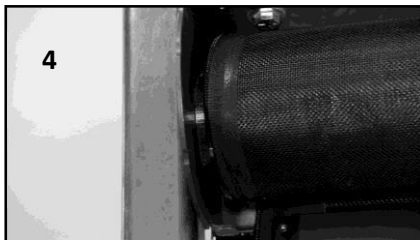
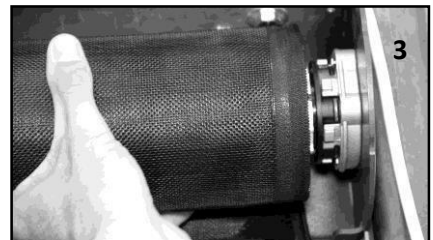
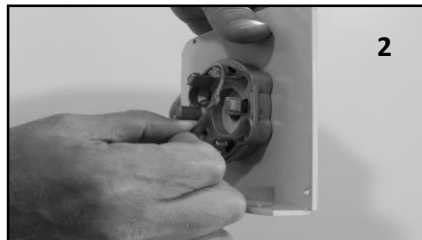
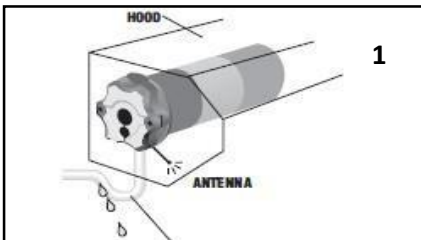

Important: in order to avoid water penetration, form a "drip loop" with the power cable and use hood

when required (#1). Remove motor clip from star bracket; set aside (#2). Remove bolt from cradle idler and place white bearing on idler pin end. Make sure wire is placed inside channel (under yellow cap). Slide motor end of shade into star bracket (#3) Slip round pin into idler (#4). Push shade in and replace bolt to lock in place. If it appears that the shade roller is not long enough, you will need to adjust the round pin. Use a 5/32" allen wrench to loosen the set screw and pull the round pin out until it can seat in the cradle idler. Reinstall motor clip onto bracket, making sure mouth snaps in place over bracket and motor head (#5-7). Feed motor wire through third hole in housing (#8). Connect motor wire into electrical source, such as junction box or plug in(#9).

CRANK OPERATED:

Remove cotter pin from cradle idler and place white bearing on round pin. Starting on gear end, insert square pin end of shade tube into hole in end cap bracket. On opposite side, slide round pin end of tube onto cradle idler end cap slot. Replace cotter pin on cradle idler to lock on place. Cotter Pin must be installed flat against the end cap as shown below.

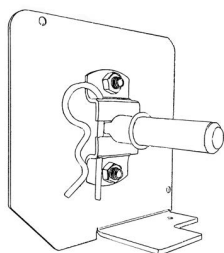

CORRECT



INCORRECT

BEFORE INSTALLING SIDE TRACKS

Verify that the fabric is centered evenly on the roller tube, as it may have shifted during shipping. If it is not centered, roll the fabric all the way down until the aluminum roller is exposed. You can then slide the fabric from side to side to center it. With vinyl panels, be careful not to remove any vinyl shims (small pieces of vinyl the factory may have inserted between the layers of rolled vinyl to make the shade roll evenly.) If they fall out, please replace them back in the same location.

4. Side Track Installation:

Lower screen until the weight bar hangs at least 5" from the bottom most portion of the housing.

Measuring/ Cutting the Side Tracks:

The side tracks are shipped according to the customers ordered height with an additional 2 inches in length. They must be cut down to the exact length needed prior to installation. Measure from the bottom left of the system housing to the floor. This will give you the required cut length for the left side track. (Note: To determine which is left or right, look at the top end cap of the side track and observe where the fabric enters the side track). Take deductions for cutting the side track from the bottom of the track. Mark the side track for cutting with the end caps left in place on the track. Verify you allowed for thickness of bottom cap in your deductions. Cut the side track to the measured length with end caps, PVC fabric guide and track cover in place. This prevents the snap in cover and fabric guide PVC from sliding out of the track housing while cutting. Remove the bottom end cap from the end scrap piece just cut off. Next, from the full length of cut side track, remove the snap-in cover. Mark the left piece L and right piece R. These will be reinstalled later. Remove burrs from the bottom of the cut side track and install the bottom end cap. If you plan to run electrical cord down the side track, now is the time to pre drill the entrance and exit holes through the top/bottom cap or somewhere else on the side track.

Attaching Side Tracks:

Determine the ideal position for the side tracks in relation to the position of the system housing. Side tracks must be placed directly below the system housing with the fabric slot in the track facing inside of the opening. The outside edge of the side track fits even with the outside edge of the system housing. Hold the side track in place and mark the inside of the open area where to drill for mounting screws.

Drill mounting holes into the sidetrack and through the mounting surface or “L” Channel Mounting Bracket. (It is a good idea to slot or round out the holes a small amount from left to right to allow for some movement during final alignment performed later).

For ease of installing screen into the side track, hold the right track at an angle, insert the zipper coil of the screen into the PVC insert located inside the side track. Install top fastener into the side track without tightening. (If using “L” Channel Mounting Brackets, the screw is put in from the BACK of the “L” Channel.) Repeat this process for the left track.

After both tracks are installed with top fasteners only, the weight bar should be riding in the side track at least 5 inches under the system housing. Use hand brace to crank shade down all the way, or press the down arrow button on the remote and allow the screen to return to its lowest limit (See step 5 at this time to adjust lower limit so shade can go all the way down as factory setting will be short.) As it does this, it will push the tracks to the best operating position.

Attach bottom fastener in each track again without tightening. Run the screen up and down to ensure there are no binding areas. Tighten top and bottom fasteners and recheck screen operation. Add the remaining fasteners, checking continually to make sure no binding has occurred. The screen material should be tight between the side tracks but loose enough to allow the screen and hem bar to travel freely. The easiest way is to start at the top and gently work down to the bottom. Install snap in cover screws. Using a manual screw driver, install the snap in cover (making sure you have the correct cover for each side track) to conceal mounting screws and electrical cord (if routed this way). Over tightening will strip the screws so that the track fronts will come off with increased wins pressure.

Attaching Optional “L” Channel Mounting Brackets:

For use when installing the system inside an opening. This 1” x 2 ½” extrusion provides a surface to fasten the side track to.

If using the optional “L” mounting brackets, cut to required length at this point. For most installations these should go from the floor to the top of the opening, continuing along the sides of the shade housing on either side. Next, install them. The back of the brackets should be lined up with the back of the housing. Make sure the bracket is mounted level to the inside of the opening, going from top to bottom. It is recommended that you pre-drill the bracket prior to final installation to the inside of the opening (do not pre-drill for the side track attachment at this time). Put in the top mounting fastener, then level the channel and put in the bottom fastener to maintain the level. Complete this installation by securing bracket with additional fasteners, top to bottom, ensuring the bracket remains level.

5. Motorized: Adjust Motor Limits

XQ5 Premium Motors

[NOTE: FOR SLIM LINE 1 AND 5 CHANNEL REMOTES] Motors and remotes come pre-programmed. Power motor and find the channel the shade is programmed to. Turn remote over, using a paper clip, press and hold the programming button to the right until motor moves. Using the up arrow, walk motor to its upper limit, fine tuning with the up and down arrows. Once you have reached your upper limits, press and hold the middle stop button until motor makes a brief jog. Now using the down arrow, walk motor to its lower position, the height the shade was ordered at. It is important to leave sufficient fabric on roller tube for proper operation. Once you have reached the lower limit, press and hold the middle stop button until motor makes a brief jog. Motor limits have been set and you shade is now in user mode.

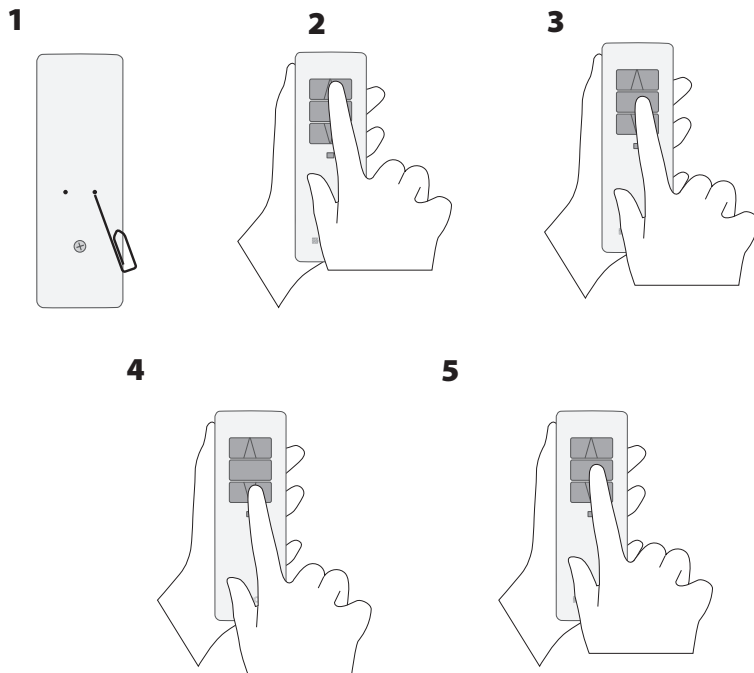

For additional shades, repeat this process for each individual shade.

6. Installing Housing Cover and Clean Up

Set housing cover into groove at top and bring down and set into place. Install the two hood screws to secure (One on each side).

You're done! Enjoy!